

15/01484/FUL

Spectus VS

A NEW ERA IN PVC-U VERTICAL SLIDER SYSTEMS

Scottish Borders Council
Town And Country
Planning (Scotland) Act
1997

REFUSED

subject to the
requirements of the
associated Decision
Notice

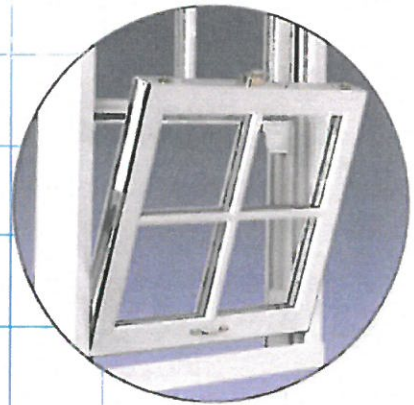

The Spectus VS is a new Vertical Slider System from Spectus.

The result of considerable investment and technical expertise, the Spectus VS has all the traditional benefits improved by modern technology.

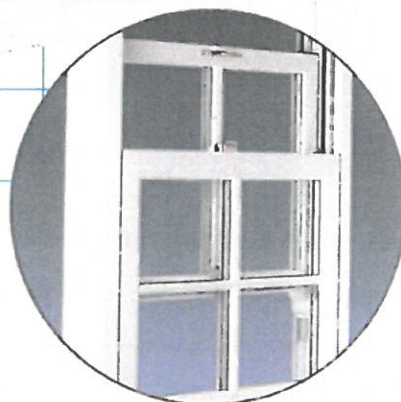

Spectus
WINDOW SYSTEMS

DETAIL SHEETS

Vertical Section - V3.

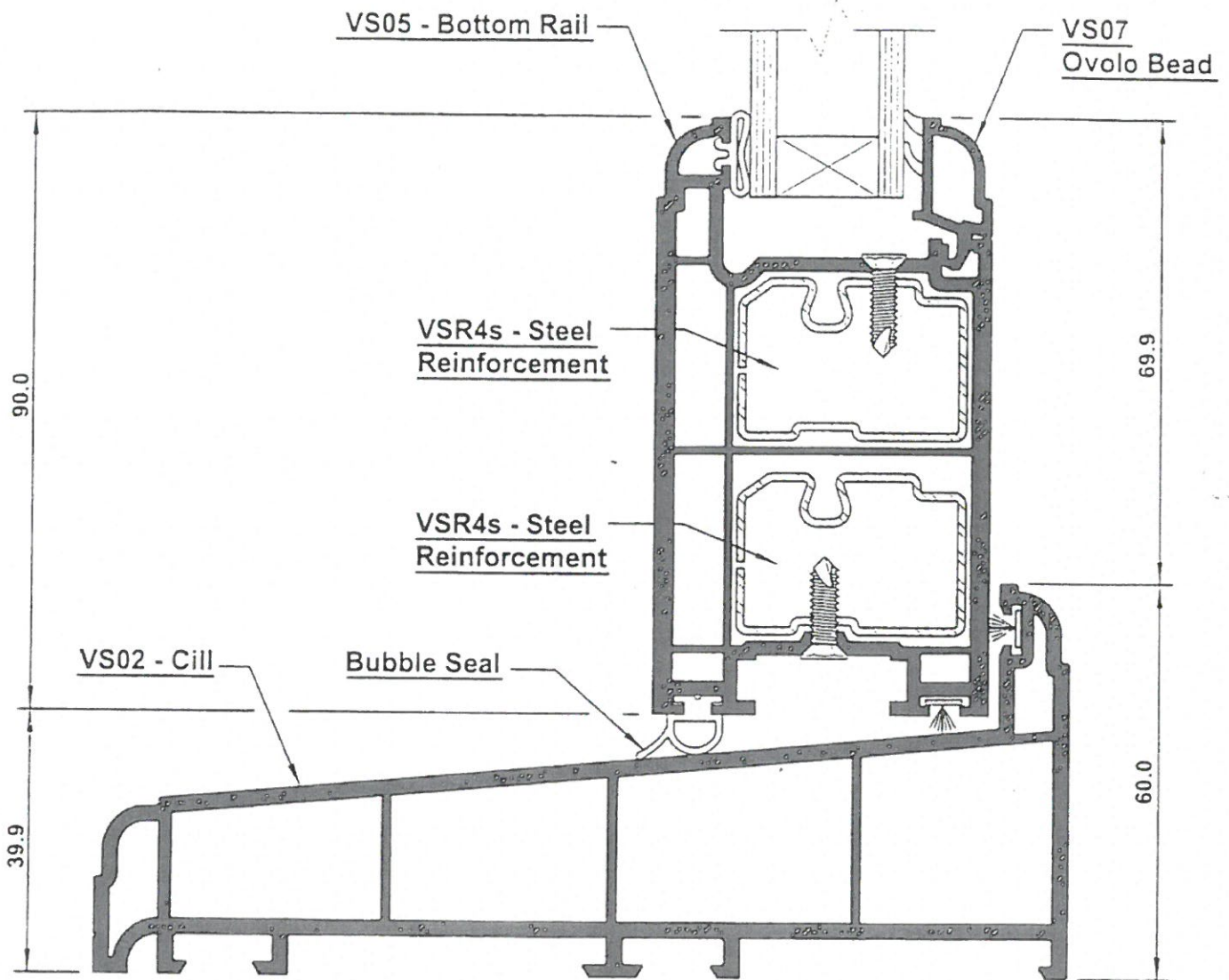

(window viewed from outside).

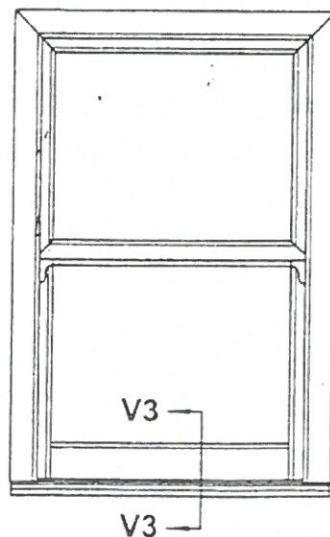

DETAIL SHEETS

Section Through Heavy Duty Configuration.

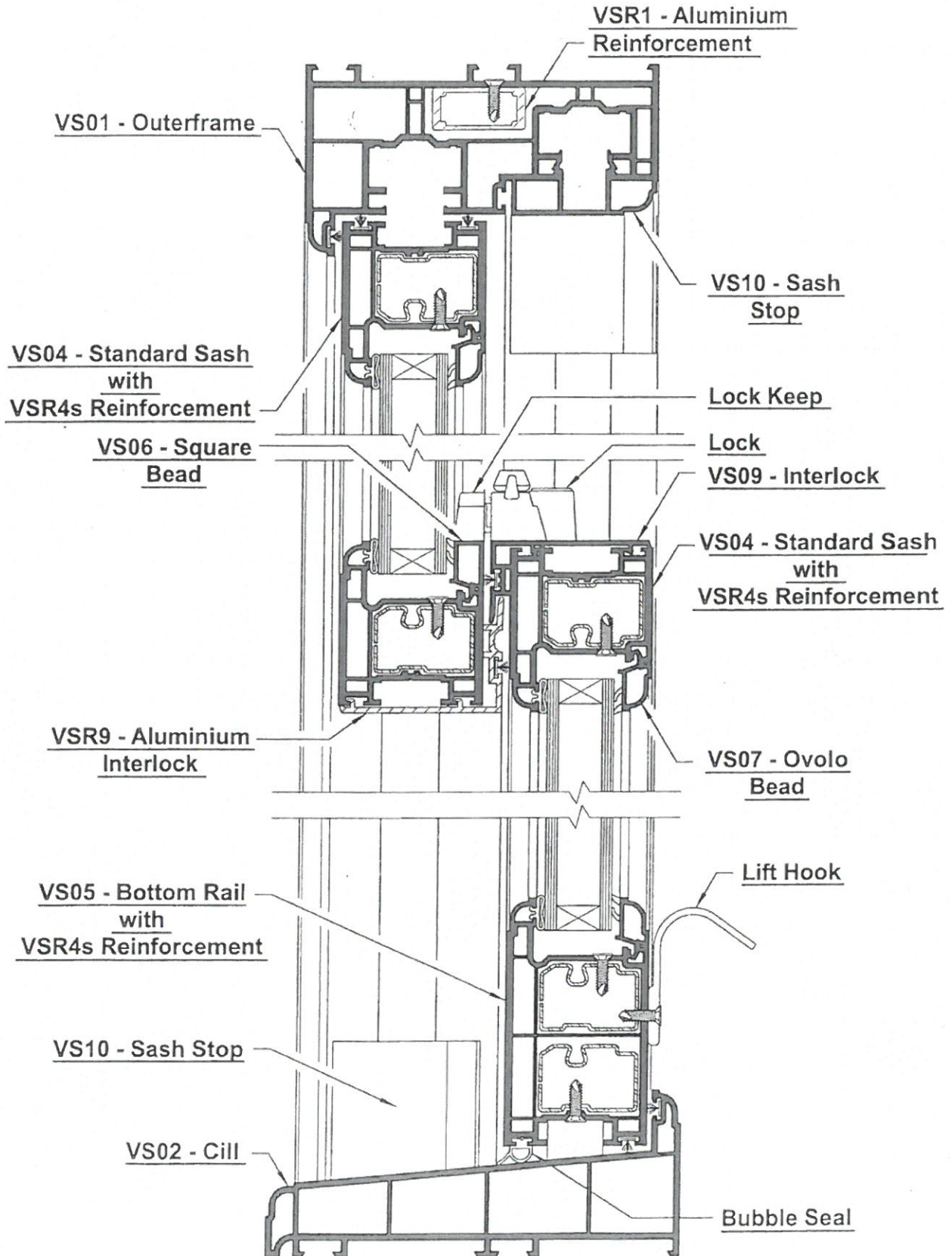

DETAIL SHEETS

Horizontal Section - H1. (Standard Configuration)

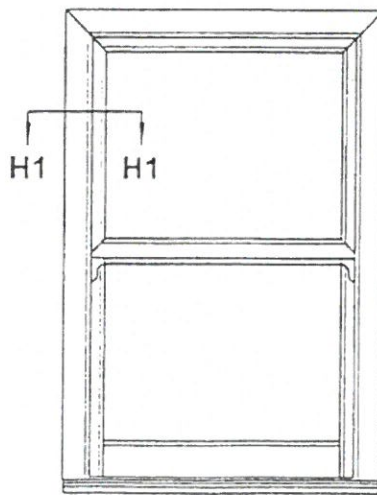
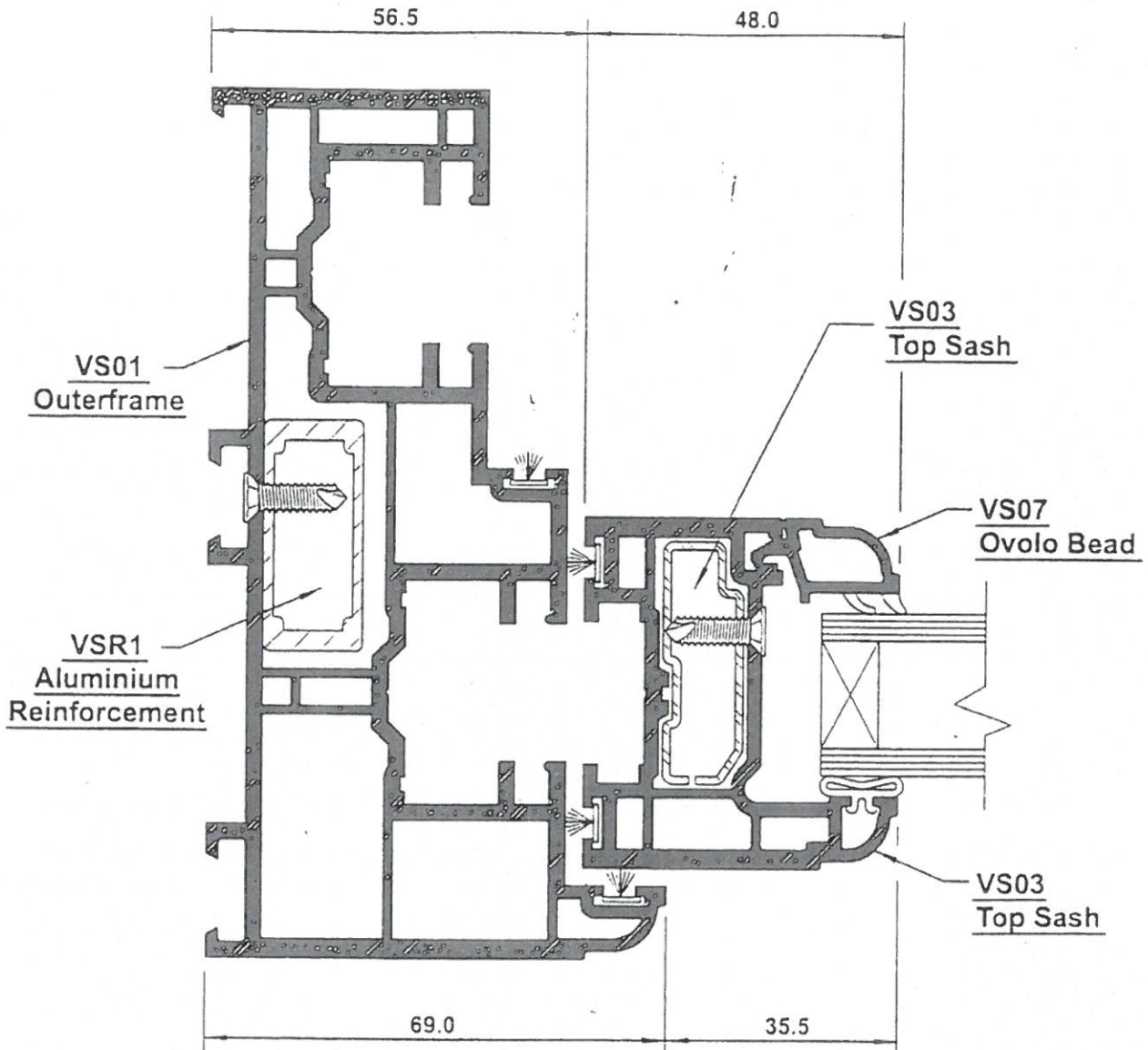

(window viewed
from outside).

DETAIL SHEETS

Horizontal Section - H2.

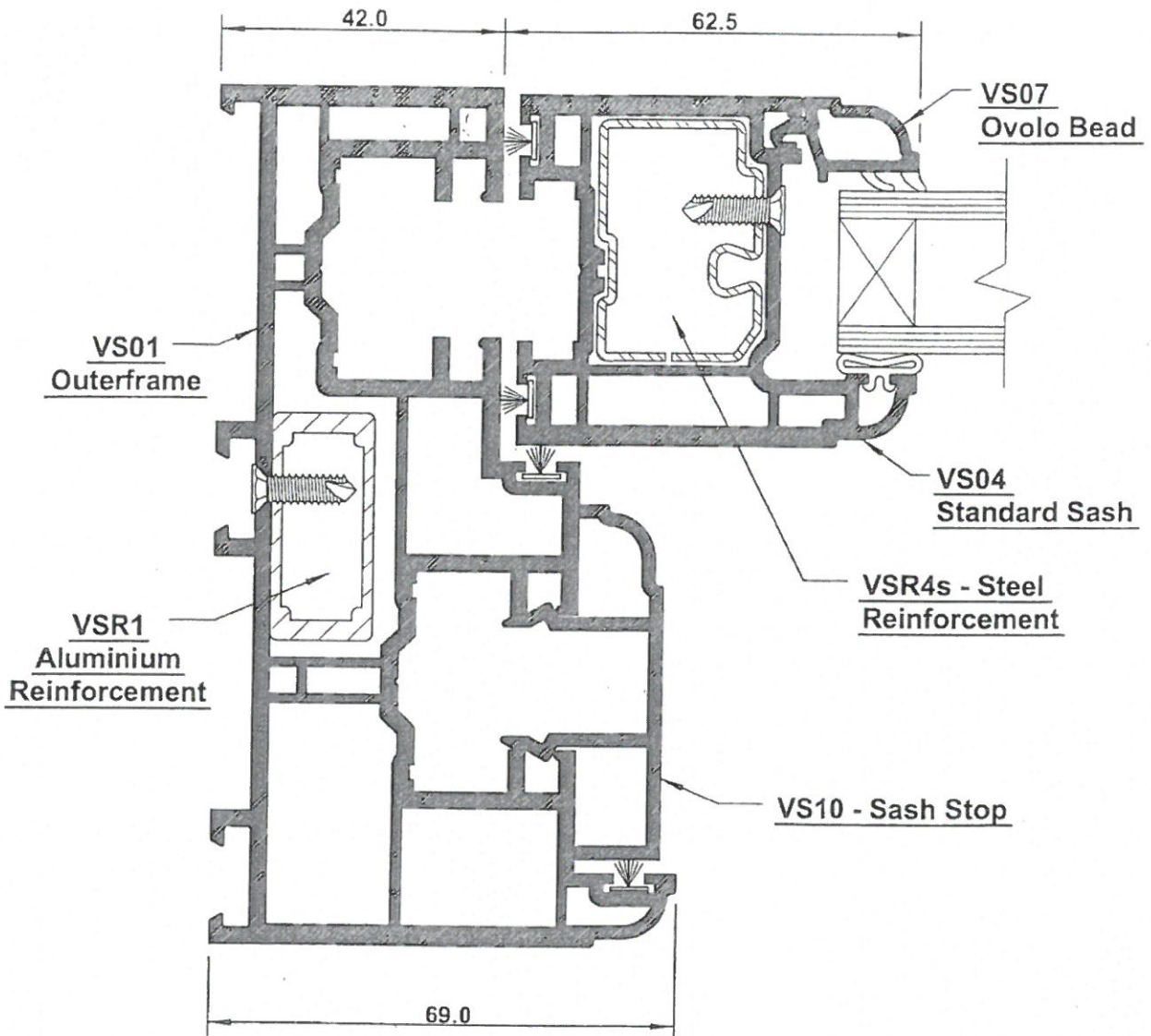

(window viewed
from outside).

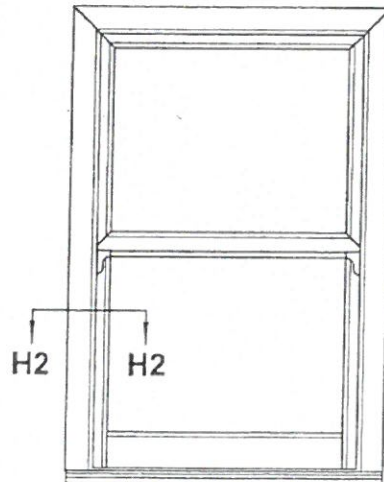

DETAIL SHEETS

Vertical Section - V1. (Standard Configuration)

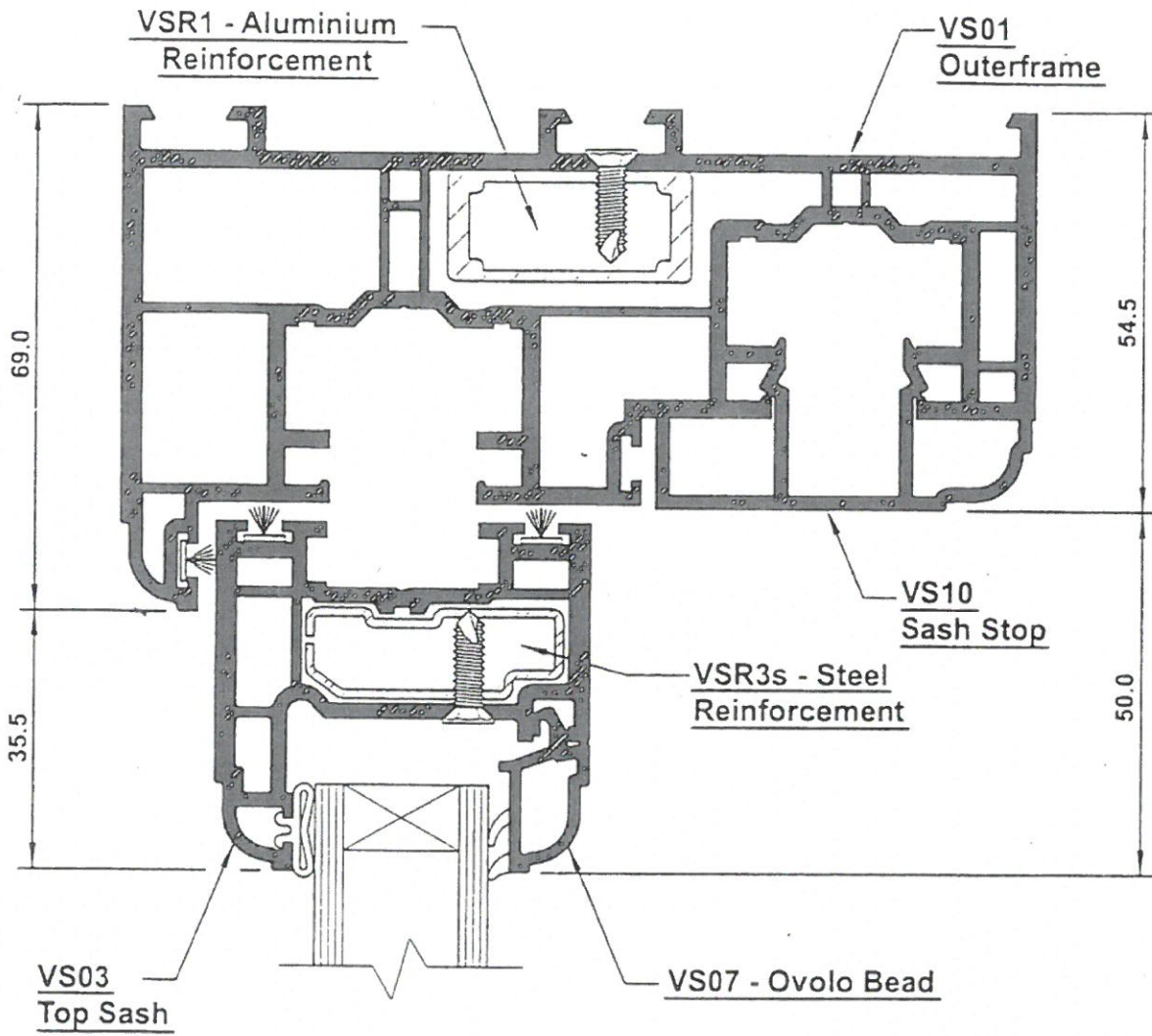

(window viewed from outside).

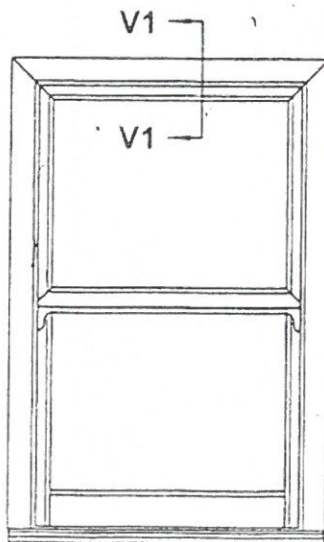

DETAIL SHEETS

Vertical Section - V2. (Standard Configuration)

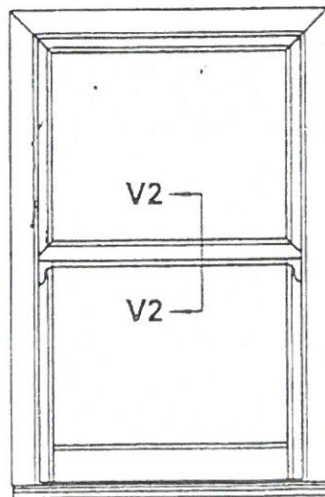
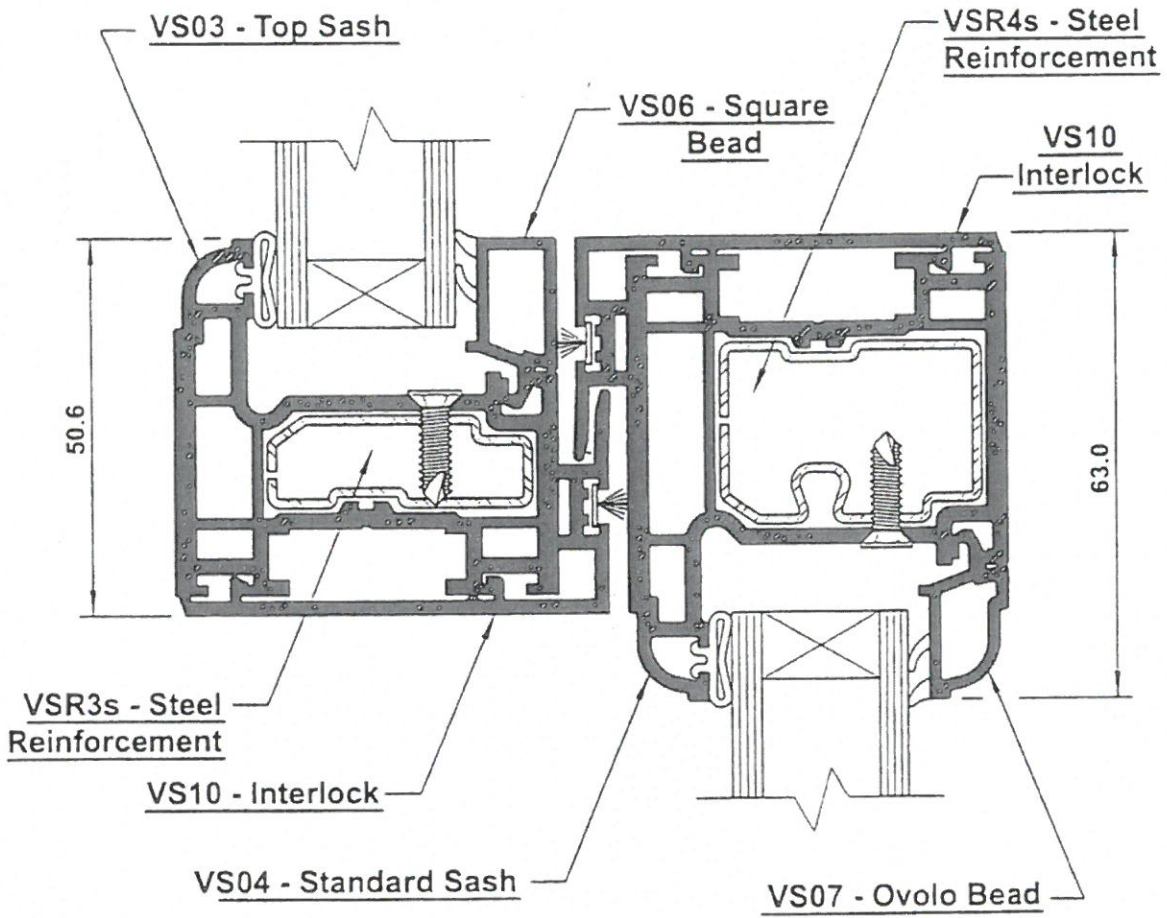

(window viewed from outside).

SightLine 70 GEORGIAN BARS

GEORGIAN BAR PROFILES

The stick on Georgian Bars are for use on 20mm, 24mm and 28mm double glazed units and SW720, 724, 728, 729, 768 and SW730 bead. They can be used on one side or on both sides of the unit.

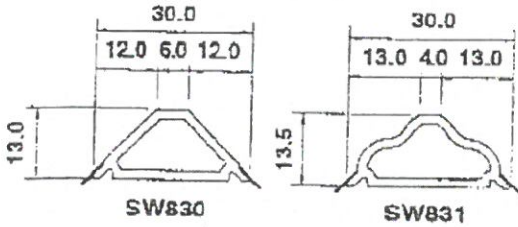

END PREPARATION

Where SW830 butts up to itself it should be cut at 45°. If it butts up to SW720 it should be cut at 40°, if it butts up to SW724, SW729 or SW768 it should be cut at 45°, if it butts up to SW728 it should be cut at 52°, if it butts up to the frame it will need end milling. See fig.1.

SW831 will need end milling to match itself on cruciforms (See fig.2) and a different cutter is required when it butts up to SW730 (See fig.3).

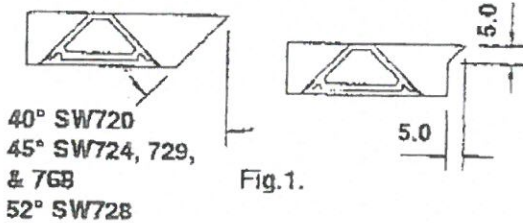
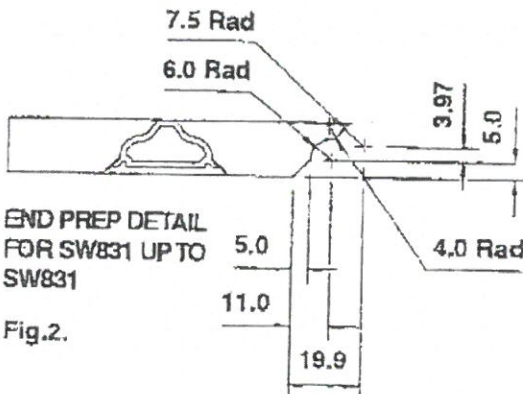
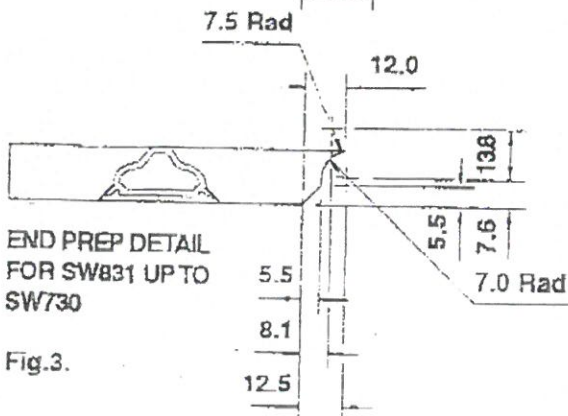

Fig.1.



END PREP DETAIL FOR SW831 UP TO SW831

Fig.2.



END PREP DETAIL FOR SW831 UP TO SW730

Fig.3.

APPLICATION

1. Using an applicator pad (900535), clean the bar with VHB surface cleaner (900533). Wipe in one direction only to avoid spreading any contamination.
2. Using an abrasive pad (900534), rub down the face of the Georgian Bar where the tape is to be applied.

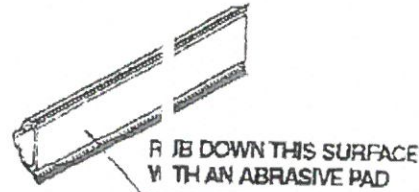

3. Using an applicator pad (900535), clean the bar with VHB surface cleaner (900533). Wipe in one direction only.
4. Allow solvent to vaporize then apply the tape (900530) and rub down evenly with a roller.
5. Using an applicator pad (900535), clean the glass with VHB surface cleaner (900533).
6. Using an applicator pad (900535), apply silane glass primer (900531) as thinly as possible, wipe in one direction only.
7. Using an applicator pad (900535), re-wipe immediately after application.
8. Remove protective liner and bond the bar to the glass ensuring the rods are not under tension.
9. Rub down with a roller to ensure good contact.

Please note: Correct application temperature is 23°C. Bars should not be applied at temperatures below 15°C. The bars should be cut 1mm shorter than the opening into which they are to be fitted.

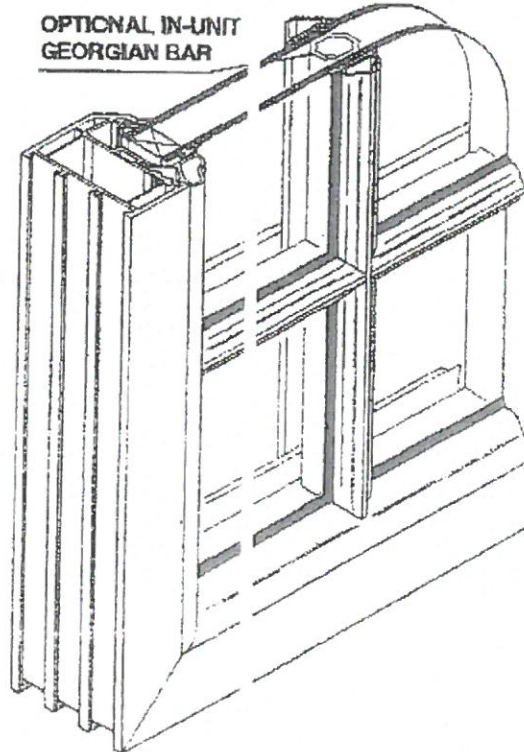

15/01484/FUL

Scottish Borders Council
Town And Country
Planning (Scotland) Act
1997

REFUSED

subject to the
requirements of the
associated Decision
Notice

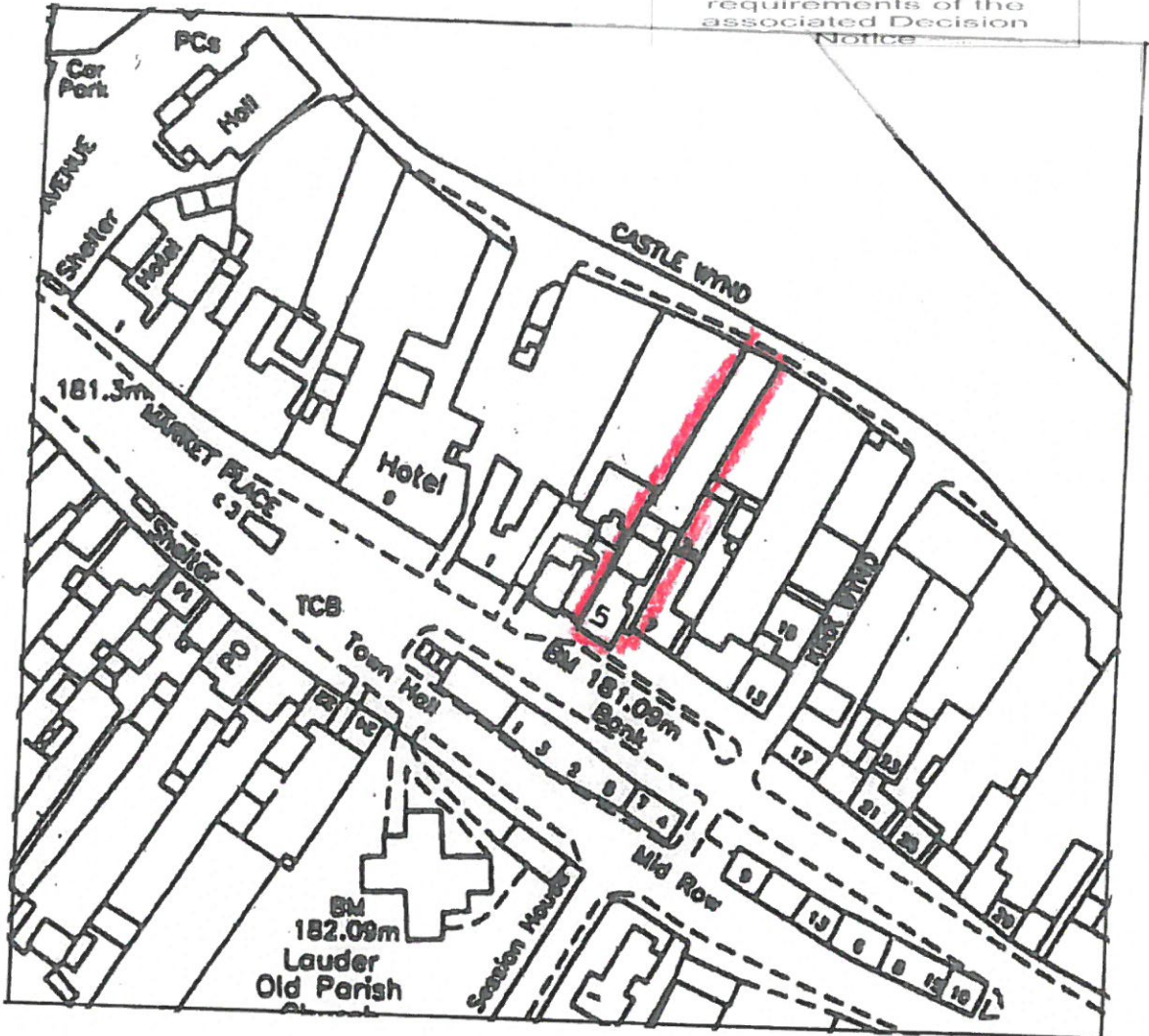

15/01484/FUL

Geoffrey Douglas, Chartered
Town and Country
Planners (Registered) and
1998

REFUSED

APPLICANT TO THE
COUNCIL FOR THE
PLANNING PERMISSION AND THE
PLANNING PERMISSION NUMBER

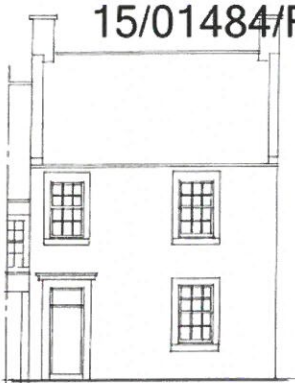

EXISTING FRONT ELEVATION



EXISTING SIDE ELEVATION



EXISTING REAR ELEVATION

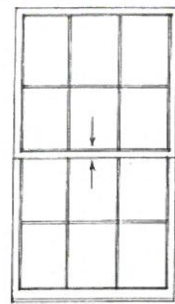

1,2

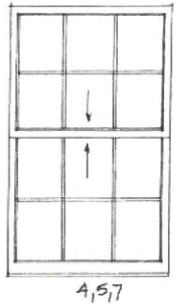

4,5,7

EXISTING WINDOWS ARE
DOUBLE GLAZED IN WHITE
PAINTED TIMBER FRAMES.

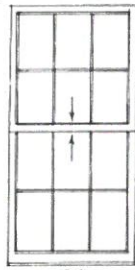

3,6

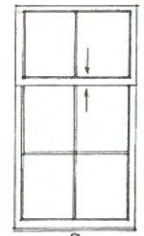

8



PROPOSED FRONT ELEVATION

0 1 2 3 4 5
1:100 SCALE



PROPOSED SIDE ELEVATION

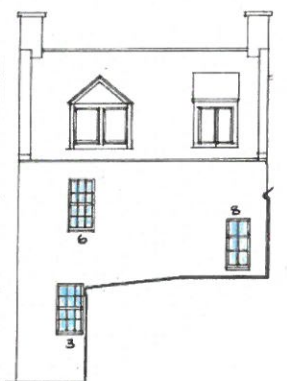

PROPOSED REAR ELEVATION

CLIENT: MRS M JACK	
5 EAST HIGH STREET	
LAUDER	
POSTCODE:	TD2 6BS
TELEPHONE:	01578 718173
PROJECT SPECIFICATION:	
INSTALLATION OF REPLACEMENT WINDOWS	
SCALE: 1:100	DATE: 11/2/15
CONTRACT NO:	P37845



PROPOSED WINDOWS TO BE
DOUBLE GLAZED IN WHITE UPVC
FRAMES AND TO BE VERTICALLY
SLIDING SASH + CASE.